

Types A, ABB, BB and BBL Insulating Bushings

For Threaded Rigid Conduit and IMC.

NEC/CEC:
Listed for Ordinary Locations

NEC/CEC:
Listed for Ordinary Locations

Type A

Applications

- To insulate end of threaded rigid and IMC.

NEC/CEC Certifications and Compliances

- UL Listed: E-11853
- CSA Certified: 065183

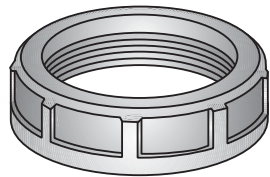

Type A

Trade Size (Inches)	Dimensions in Millimeters (Inches)		
	Outside Dia.	Overall Height	Catalog Number
1/2	28.70 (1.13)	12.70 (0.50)	A-50
3/4	35.05 (1.38)	12.70 (0.50)	A-75
1	44.45 (1.75)	16.00 (0.63)	A-100
1-1/4	54.10 (2.13)	19.05 (0.75)	A-125
1-1/2	60.45 (2.38)	19.05 (0.75)	A-150
2	73.15 (2.88)	19.05 (0.75)	A-200
2-1/2	85.85 (3.38)	22.35 (0.88)	A-250
3	101.60 (4.00)	22.35 (0.88)	A-300
3-1/2	117.60 (4.63)	22.35 (0.88)	A-350
4	130.30 (5.13)	22.35 (0.88)	A-400
5	158.75 (6.25)	28.70 (1.13)	A-500
6	187.45 (7.38)	28.70 (1.13)	A-600

Type BB

Applications

- To insulate cables passing through metal boxes or troughs.

NEC/CEC Certifications and Compliances

- UL Listed: E-20933
- CSA Certified: 11584

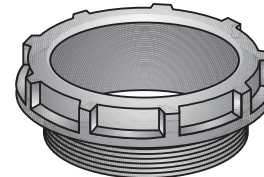

Type BB

Trade Size (Inches)	Dimensions in Millimeters (Inches)			
	Outside Dia.	Bushing Hole Dia.	Thread Length	Catalog Number
1/2	28.70 (1.13)	16.00 (0.63)	9.65 (0.38)	BB-50
3/4	35.05 (1.38)	19.05 (0.75)	9.65 (0.38)	BB-75
1	44.45 (1.75)	25.40 (1.00)	12.70 (0.50)	BB-100
1-1/4	54.10 (2.13)	31.75 (1.25)	12.70 (0.50)	BB-125
1-1/2	60.45 (2.38)	38.10 (1.50)	12.70 (0.50)	BB-150
2	73.15 (2.88)	50.80 (2.00)	12.70 (0.50)	BB-200
2-1/2	85.85 (3.38)	60.45 (2.38)	16.00 (0.63)	BB-250
3	101.60 (4.00)	76.20 (3.00)	16.00 (0.63)	BB-300
3-1/2	117.60 (4.63)	88.90 (3.50)	16.00 (0.63)	BB-350
4	130.30 (5.13)	98.55 (3.88)	16.00 (0.63)	BB-400
5	158.75 (6.25)	123.95 (4.88)	19.05 (0.75)	BB-500
6	187.45 (7.38)	149.35 (5.88)	19.05 (0.75)	BB-600

Types A, ABB, BB and BBL Insulating Bushings

For Threaded Rigid Conduit and IMC.

NEC/CEC:
Listed for Ordinary Locations

Type ABB

Applications

- A combination of Type "A" and "BB" Bushings. For insulating cables passing through metal boxes or troughs.

Features

- High impact black thermosetting phenolic bushings, with at +150 °C (+302 °F) UL temperature rating, that will not soften, melt or burn.

NEC/CEC Certifications and Compliances

- UL Listed: E-20933
- CSA Certified: 011584
- UL Standard: ANSI/UL 514B
- CSA Standard: C22.2 No. 18
- NEMA Standard: FB-1

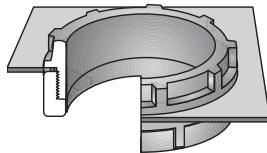

Type ABB

Dimensions in Millimeters (Inches)							
Trade Size (Inches)	Outside Dia.	Hole Dia.	Thread Length	Shd. Ht. Type "BB"	Type "A"	Max. Encl. Thick	Catalog Number
1/2	28.70 (1.13)	16.00 (0.63)	9.65 (0.38)	6.35 (0.25)	12.70 (0.50)	3.30 (0.13)	ABB-50
3/4	35.05 (1.38)	19.05 (0.75)	9.65 (0.38)	6.35 (0.25)	12.70 (0.50)	3.30 (0.13)	ABB-75
1	44.45 (1.75)	25.40 (1.00)	12.70 (0.50)	9.65 (0.38)	16.00 (0.63)	6.35 (0.25)	ABB-100
1-1/4	54.10 (2.13)	31.75 (1.25)	12.70 (0.50)	9.65 (0.38)	19.05 (0.75)	6.35 (0.25)	ABB-125
1-1/2	60.45 (2.38)	38.10 (1.50)	12.70 (0.50)	9.65 (0.38)	19.05 (0.75)	6.35 (0.25)	ABB-150
2	73.15 (2.88)	50.80 (2.00)	12.70 (0.50)	12.70 (0.50)	19.05 (0.75)	6.35 (0.25)	ABB-200
2-1/2	85.85 (3.38)	60.45 (2.38)	16.00 (0.63)	12.70 (0.50)	22.35 (0.88)	6.35 (0.25)	ABB-250
3	101.60 (4.00)	76.20 (3.00)	16.00 (0.63)	12.70 (0.50)	22.35 (0.88)	6.35 (0.25)	ABB-300
3 -/2	117.60 (4.63)	88.90 (3.50)	16.00 (0.63)	12.70 (0.50)	22.35 (0.88)	6.35 (0.25)	ABB-350
4	130.30 (5.13)	98.55 (3.88)	16.00 (0.63)	12.70 (0.50)	22.35 (0.88)	6.35 (0.25)	ABB-400
5	158.75 (6.25)	123.95 (4.88)	19.05 (0.75)	12.70 (0.50)	28.70 (1.13)	6.35 (0.25)	ABB-500
6	187.45 (7.38)	149.35 (5.88)	19.05 (0.75)	12.70 (0.50)	28.70 (1.13)	6.35 (0.25)	ABB-600

Type BBL

Applications

- Type BB provided with a steel locknut.

NEC/CEC Certifications and Compliances

- UL Listed: E-20933
- CSA Certified: 11584

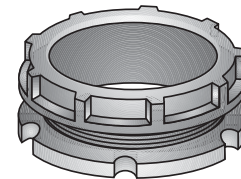

Type BBL

Dimensions in Millimeters (Inches)					
Trade Size (Inches)	Bushing Outside Dia.	Hole Dia.	Locknut Thread Length	Max Dia.	Catalog Number
1/2	16.00 (0.63)	16.00 (0.63)	9.65 (0.38)	28.70 (1.13)	BBL-50
3/4	19.05 (0.75)	19.05 (0.75)	9.65 (0.38)	38.10 (1.50)	BBL-75
1	25.40 (1.00)	25.40 (1.00)	12.70 (0.50)	44.45 (1.75)	BBL-100
1-1/4	31.75 (1.25)	31.75 (1.25)	12.70 (0.50)	60.45 (2.38)	BBL-125
1-1/2	38.10 (1.50)	38.10 (1.50)	12.70 (0.50)	66.8 (2.63)	BBL-150
2	50.80 (2.00)	50.80 (2.00)	12.70 (0.50)	79.50 (3.13)	BBL-200
2-1/2	60.45 (2.38)	60.45 (2.38)	16.00 (0.63)	92.20 (3.63)	BBL-250
3	76.20 (3.00)	76.20 (3.00)	16.00 (0.63)	111.25 (4.38)	BBL-300
3-1/2	88.90 (3.50)	88.90 (3.50)	16.00 (0.63)	127.00 (5.00)	BBL-350
4	98.55 (3.88)	98.55 (3.88)	16.00 (0.63)	139.70 (5.50)	BBL-400
5	123.95 (4.88)	123.95 (4.88)	19.05 (0.75)	174.75 (6.88)	BBL-500
6	149.35 (5.88)	149.35 (5.88)	19.05 (0.75)	203.2 (8.00)	BBL-600